

RESILIENT

Home Building Conference

March 19-21, 2010  Convention Center, Biloxi, MS



RESILIENT FLOOR, WALL AND ROOF FRAMING

David Perkes, AIA

GCCDS Gulf Coast Community Design Studio





09/19/2007



10/03/2007



09/19/2007

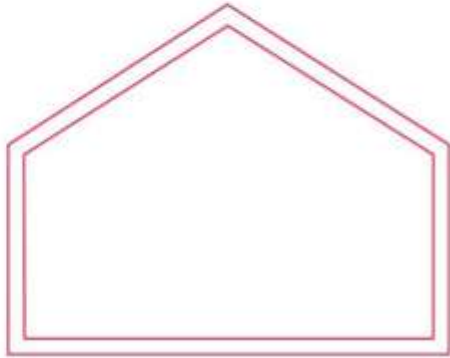

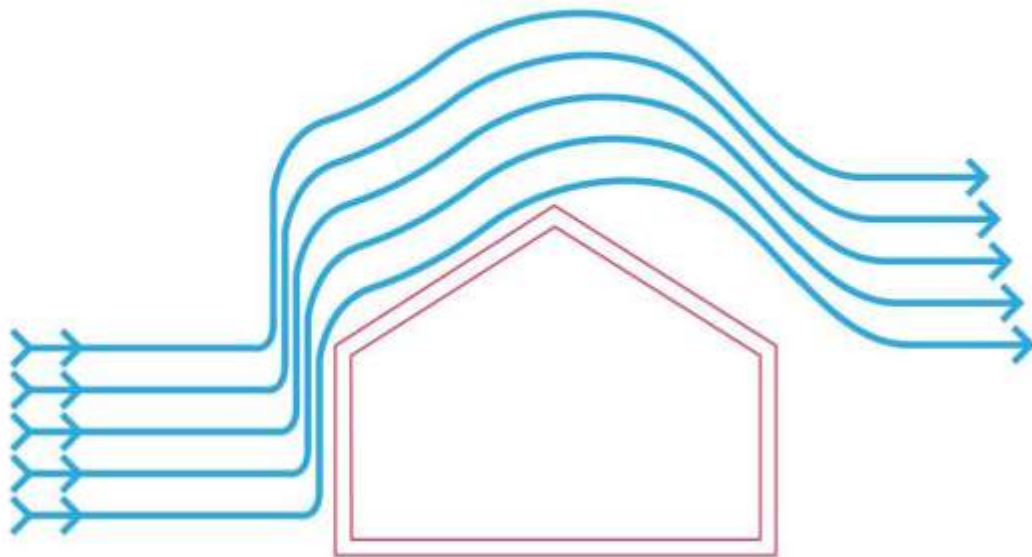

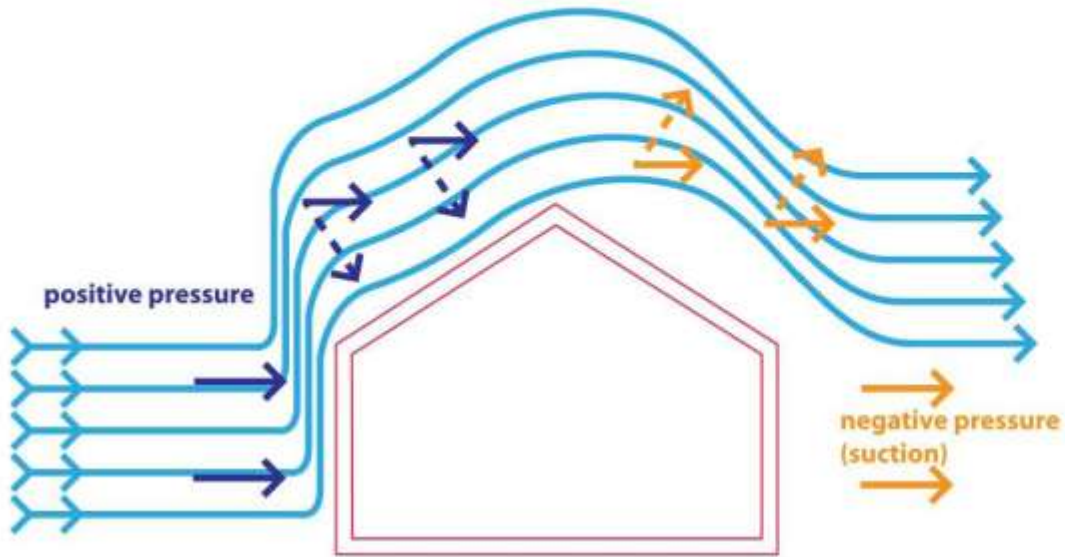

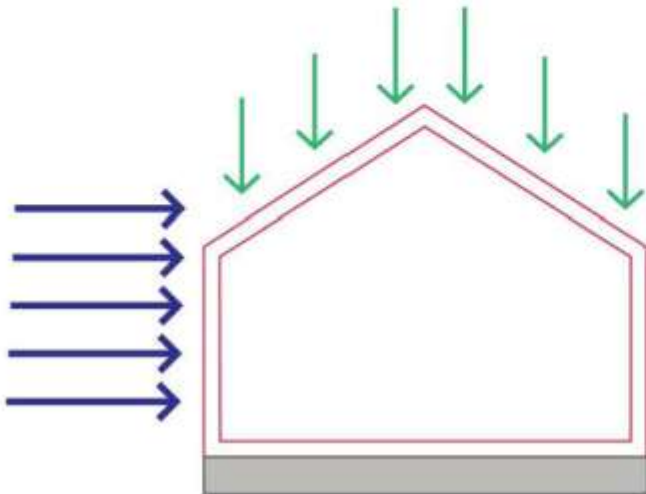

140-150 MPH wind
35-40 psf
(depending on exposure)

Vertical Load 2006 IBC
20 psf

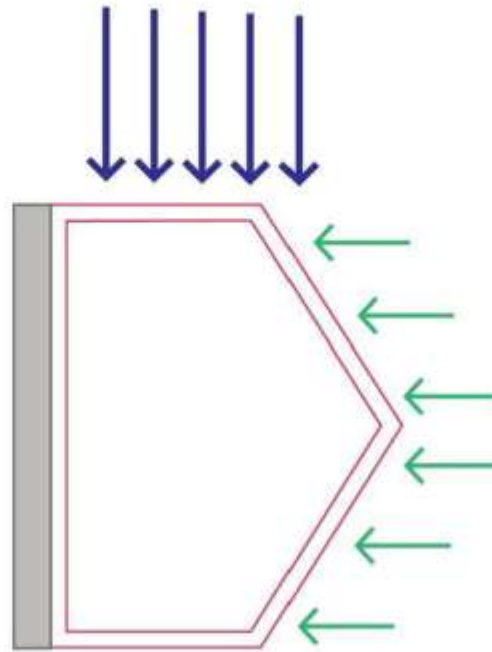

140-150 MPH wind
35-40 psf
(depending on exposure)

Vertical Load 2006 IBC
20 psf

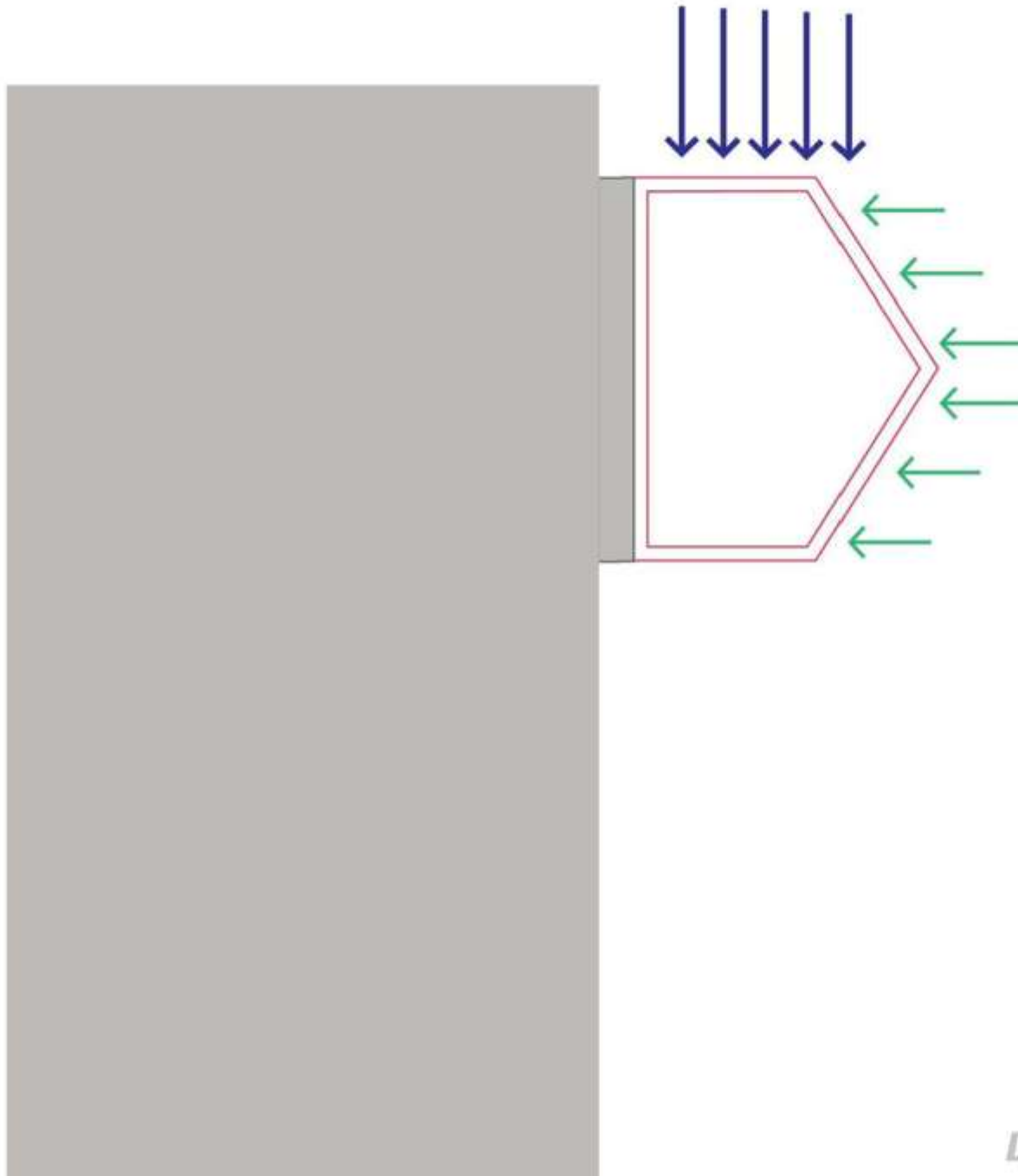

LATERAL FORCES - WIND LOAD

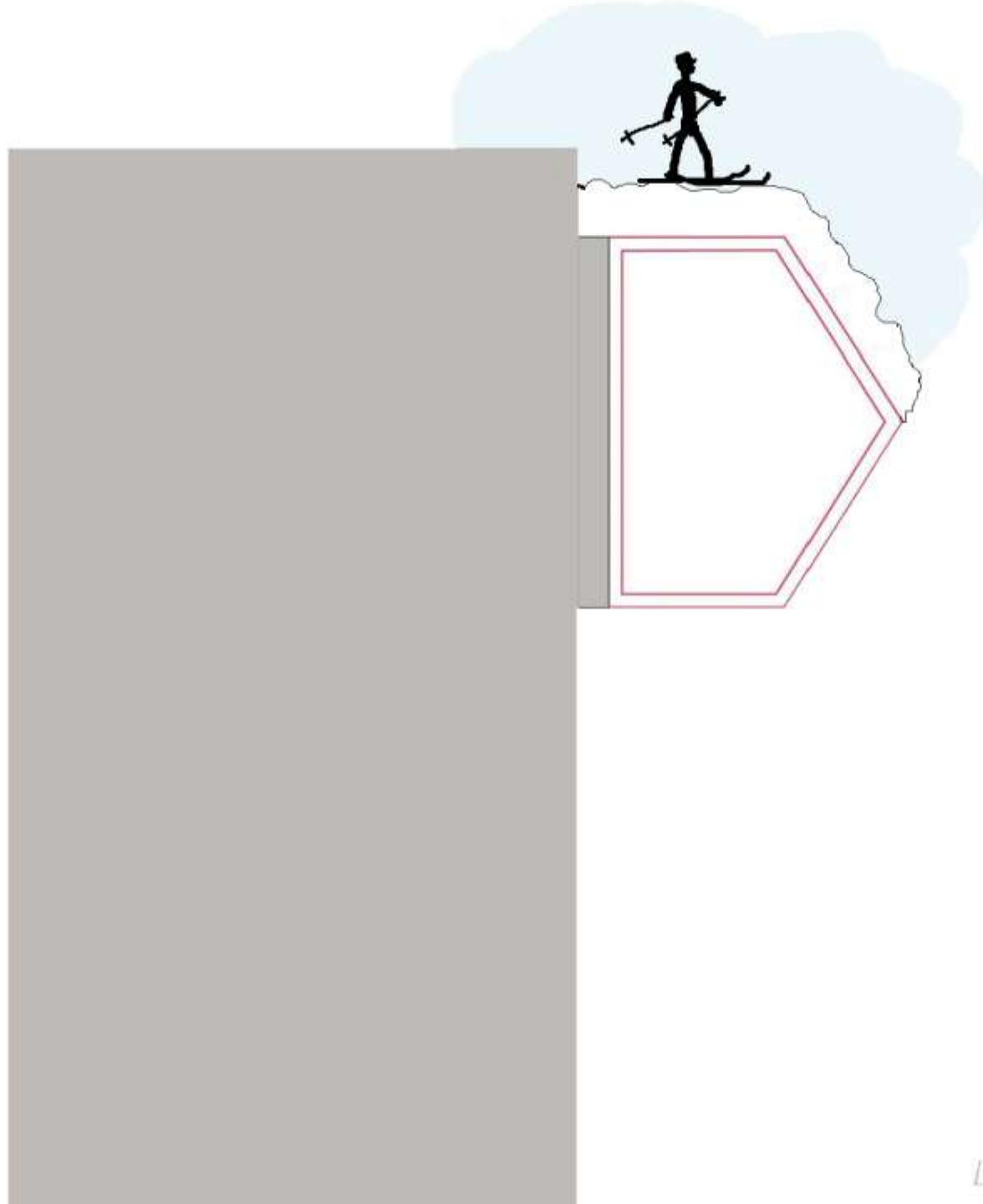

LATERAL FORCES - WIND LOAD



09/19/2007



09/19/2007



09/19/2007



09/19/2007



09/19/2007



09/19/2007



09/19/2007



09/19/2007



09/19/2007



09/19/2007



09/19/2007



09/19/2007



09/19/2007



09/19/2007



09/19/2007



09/19/2007



09/19/2007



09/19/2007



09/19/2007



09/19/2007



09/19/2007



09/19/2007



09/19/2007



09/19/2007



09/19/2007



09/19/2007



09/19/2007



09/19/2007



09/19/2007



09/19/2007



09/19/2007

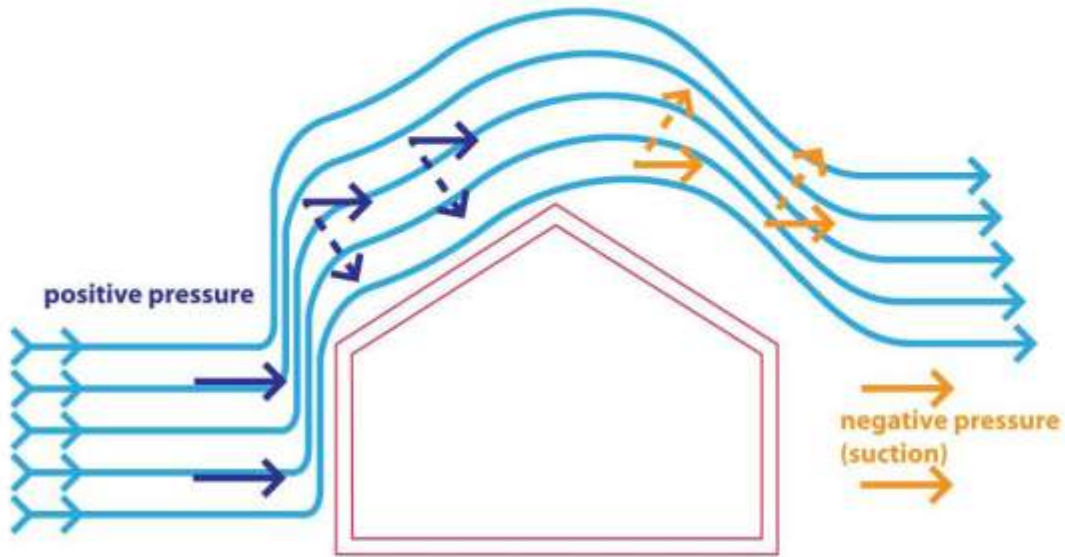

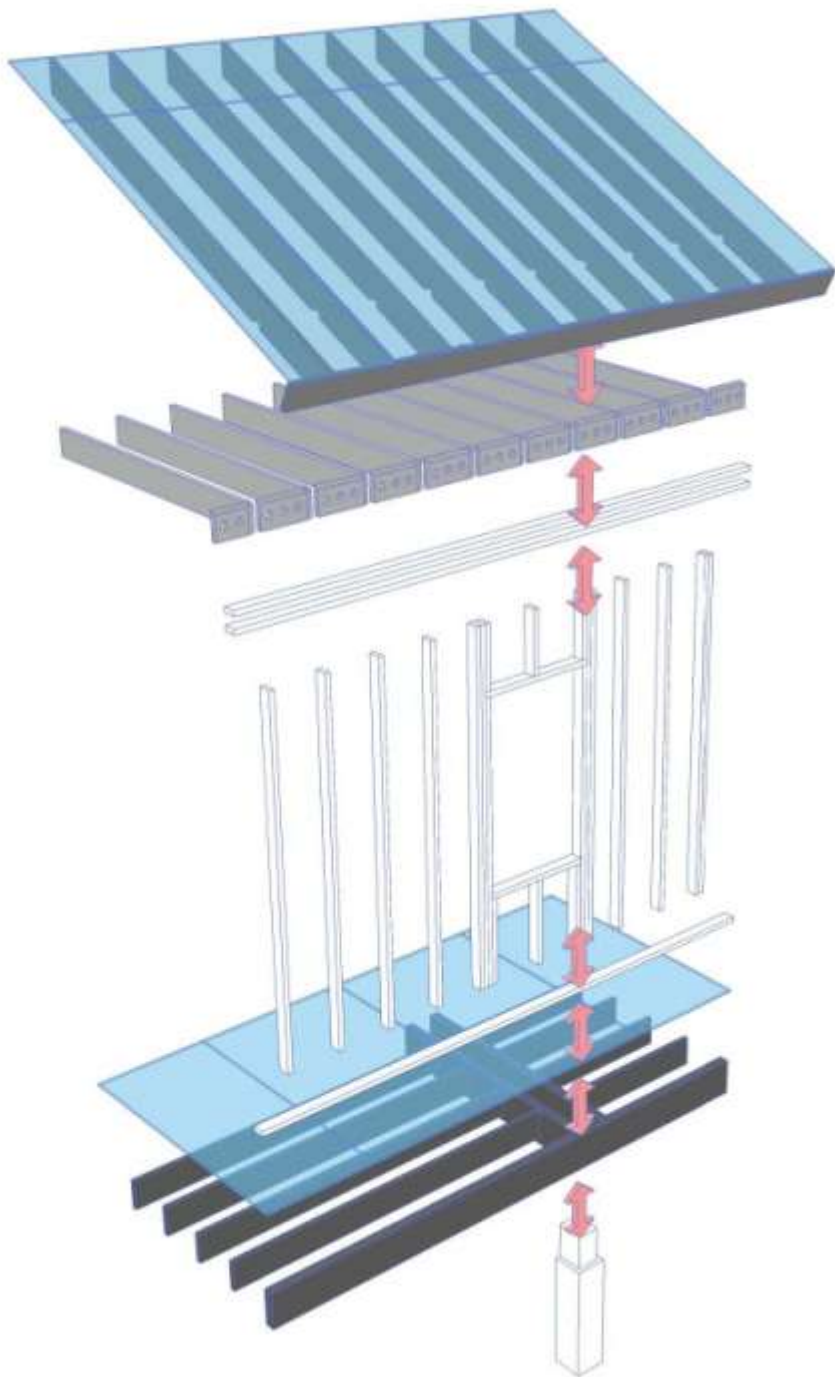

VERTICAL LOAD PATH (UPLIFT)

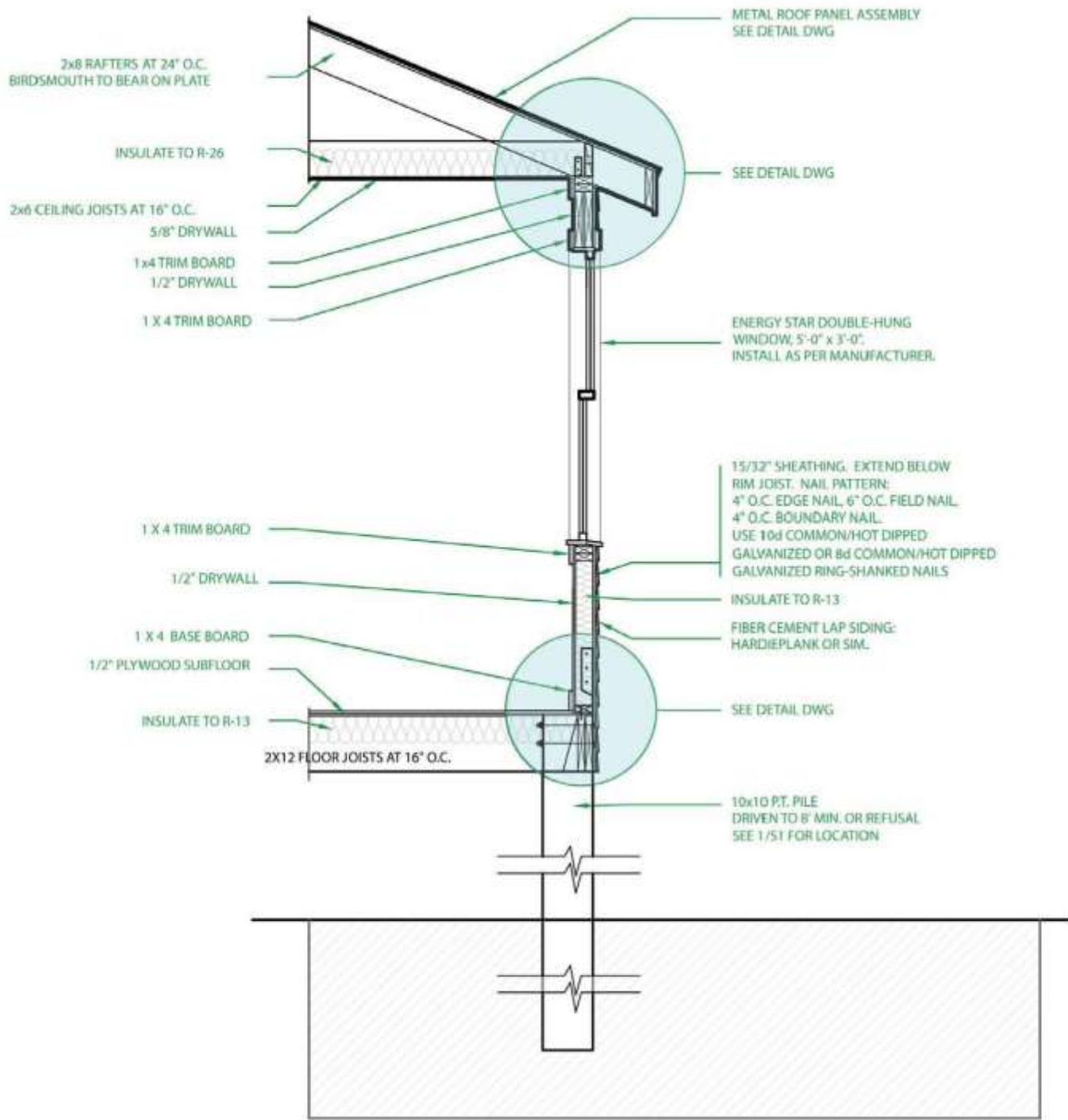

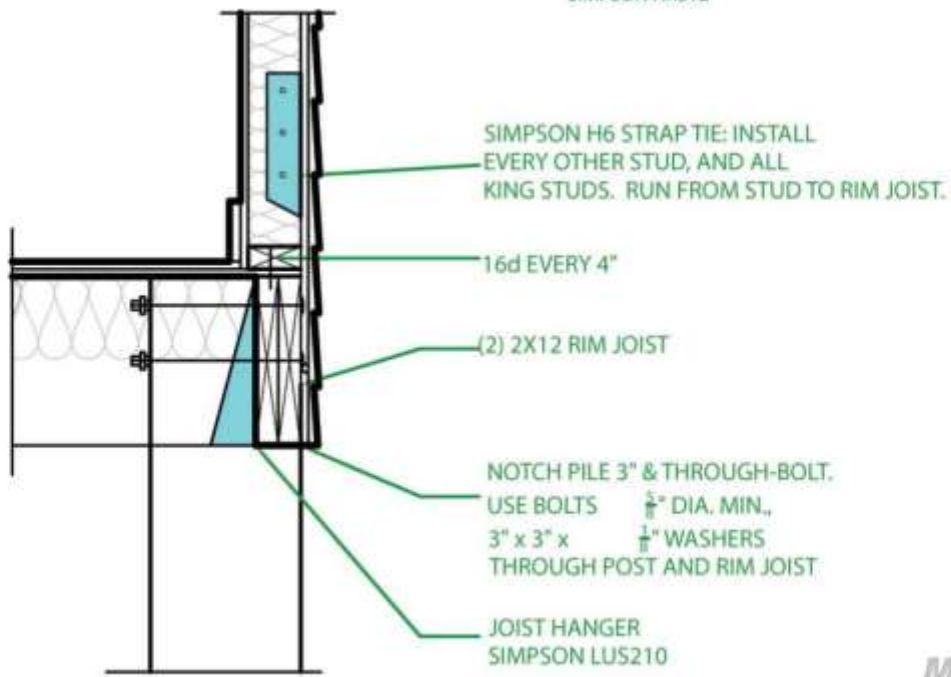
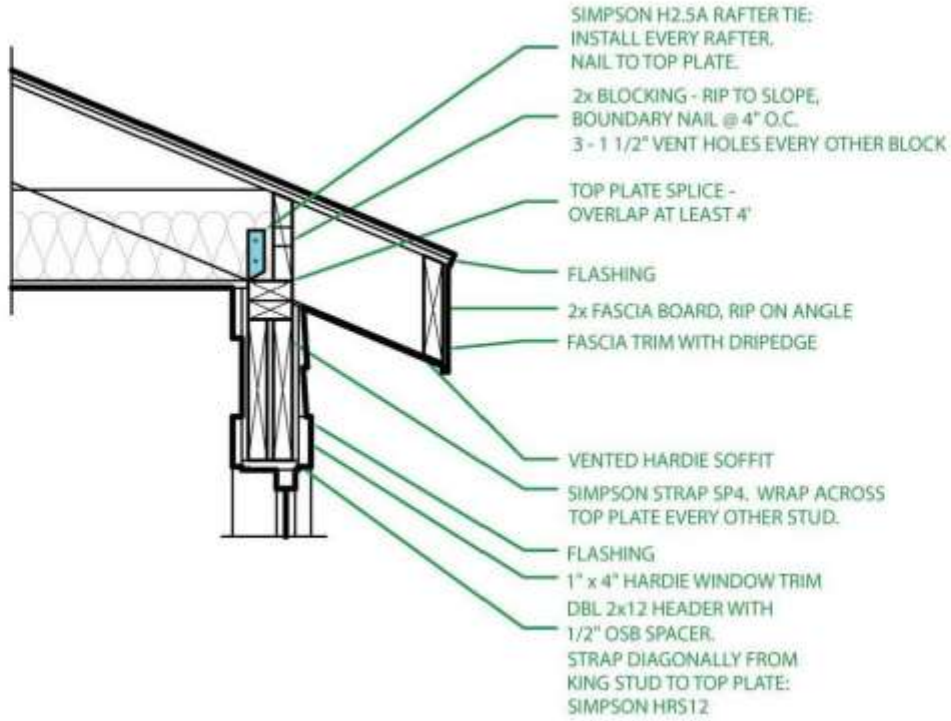

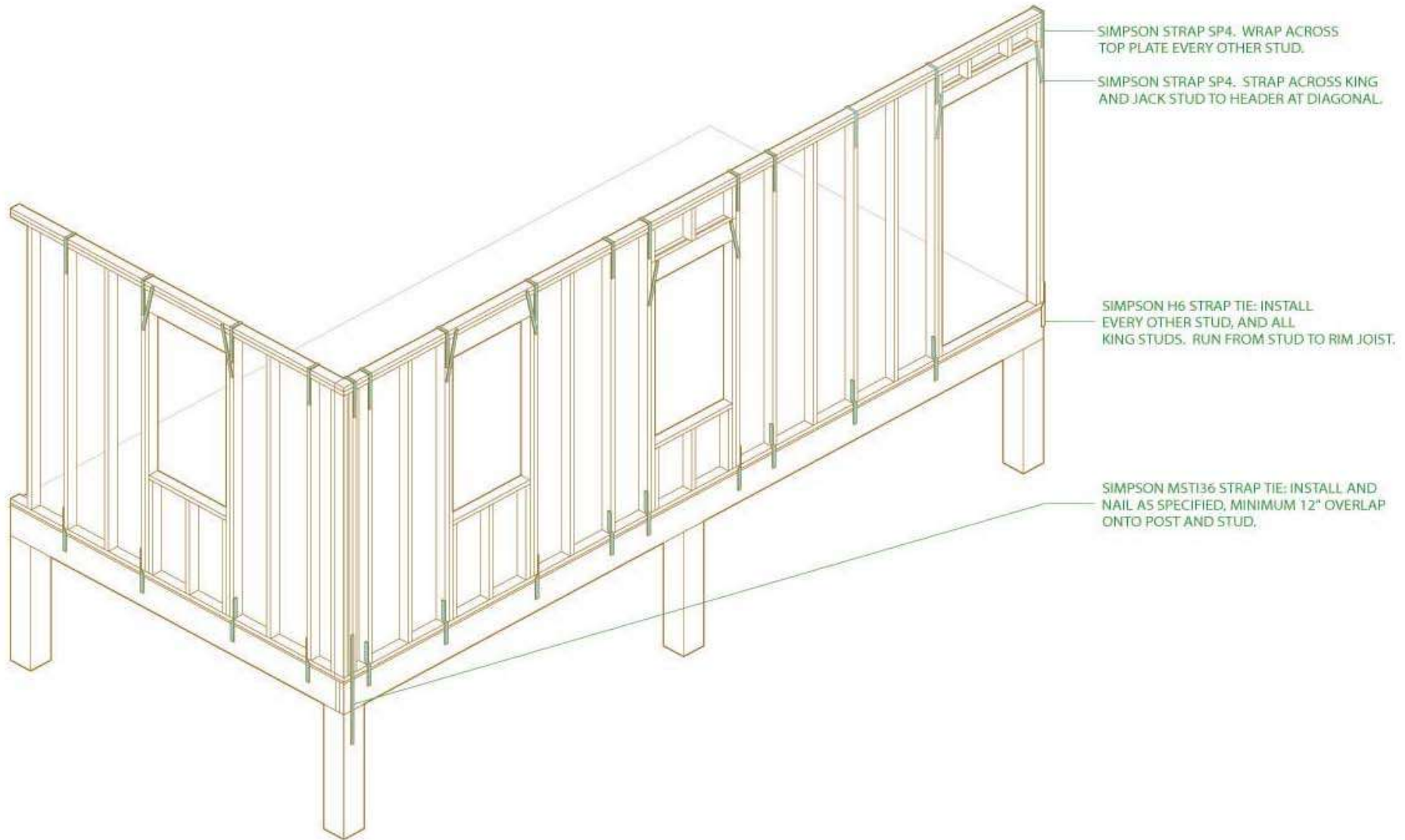



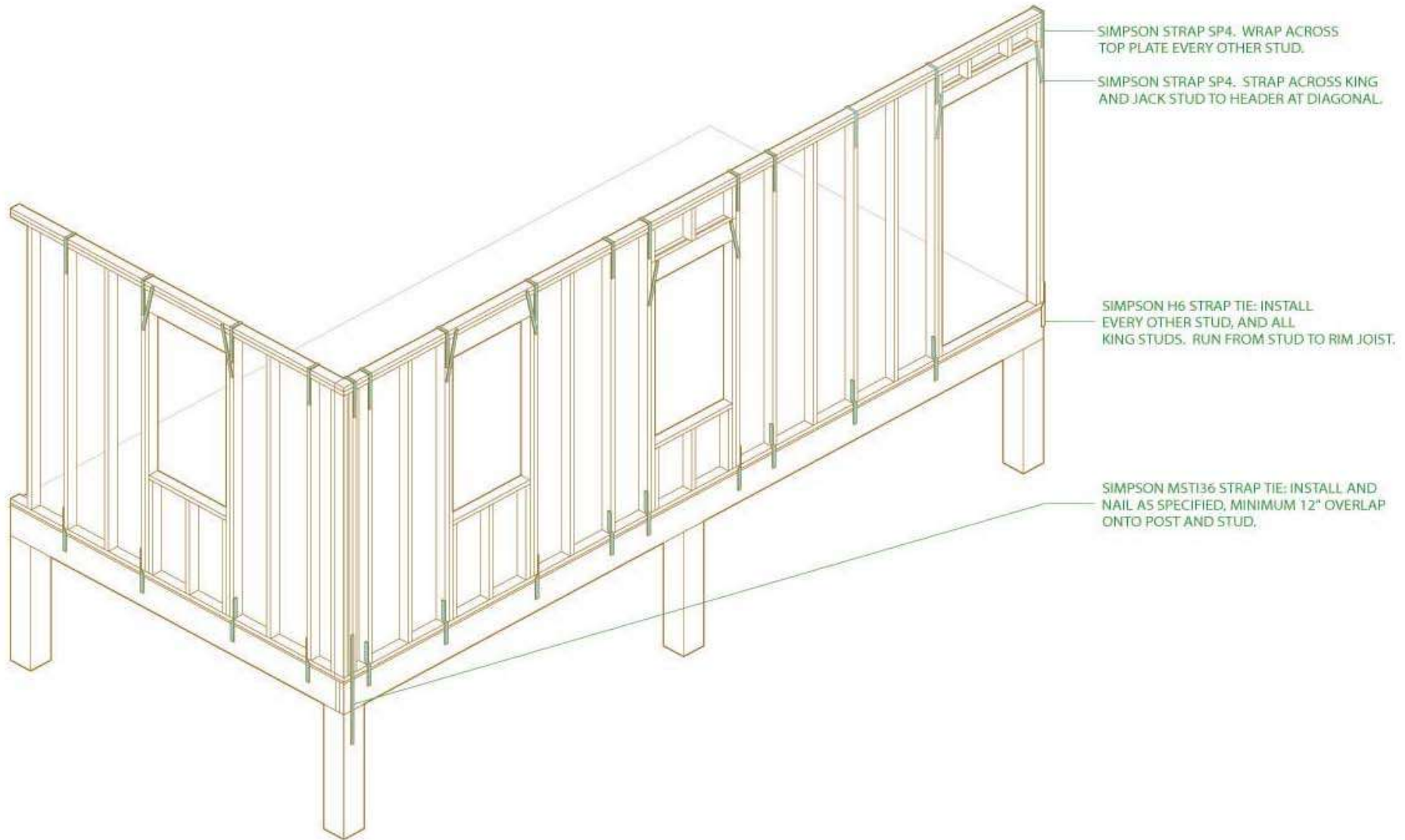



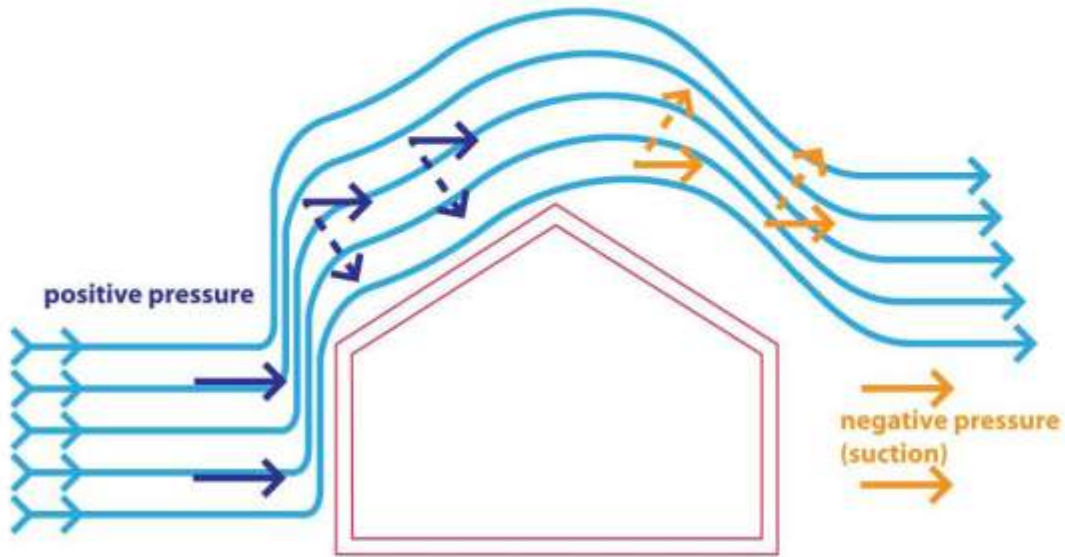

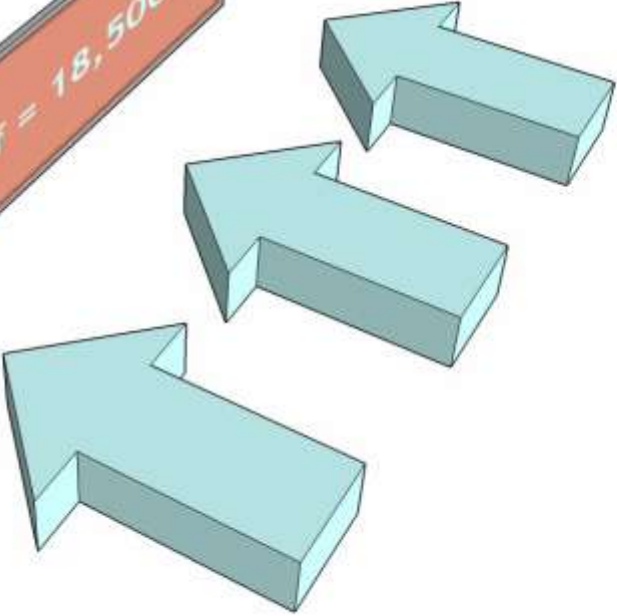
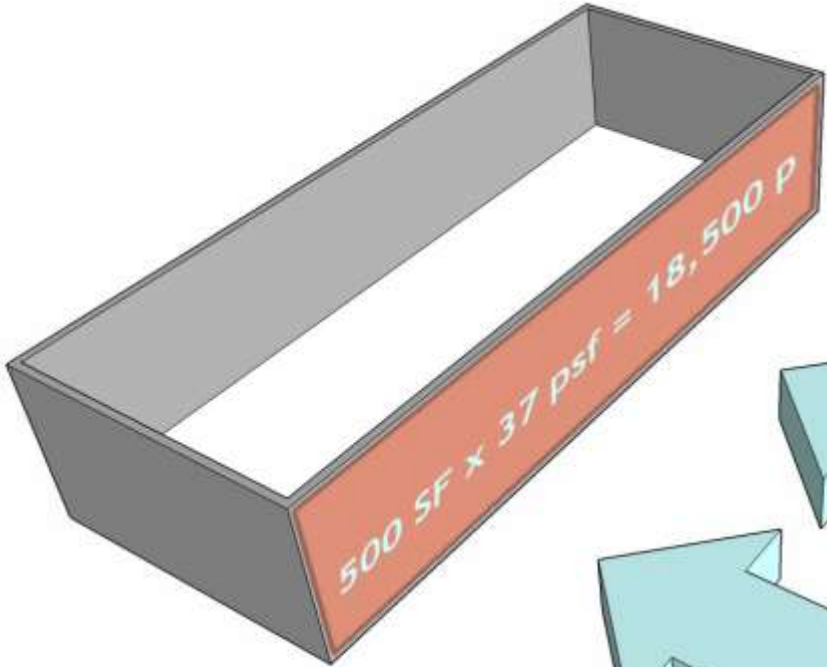

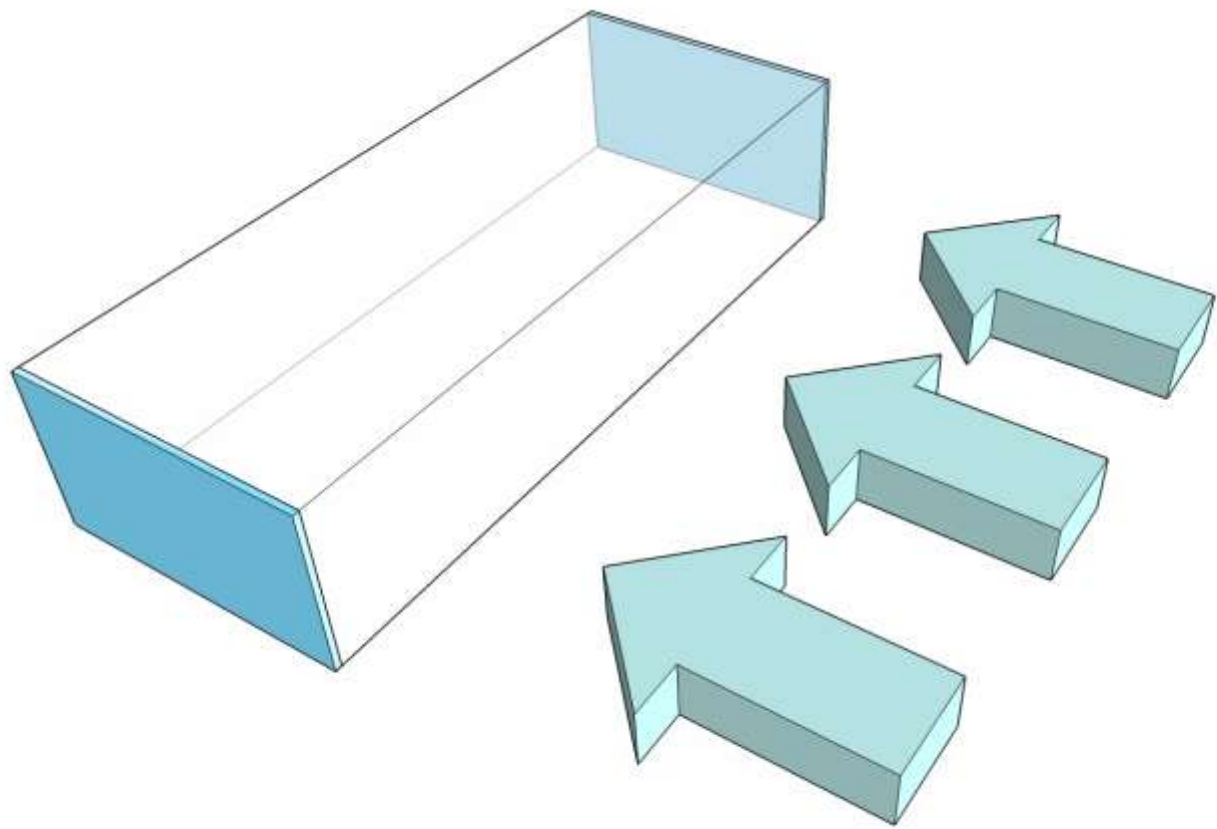

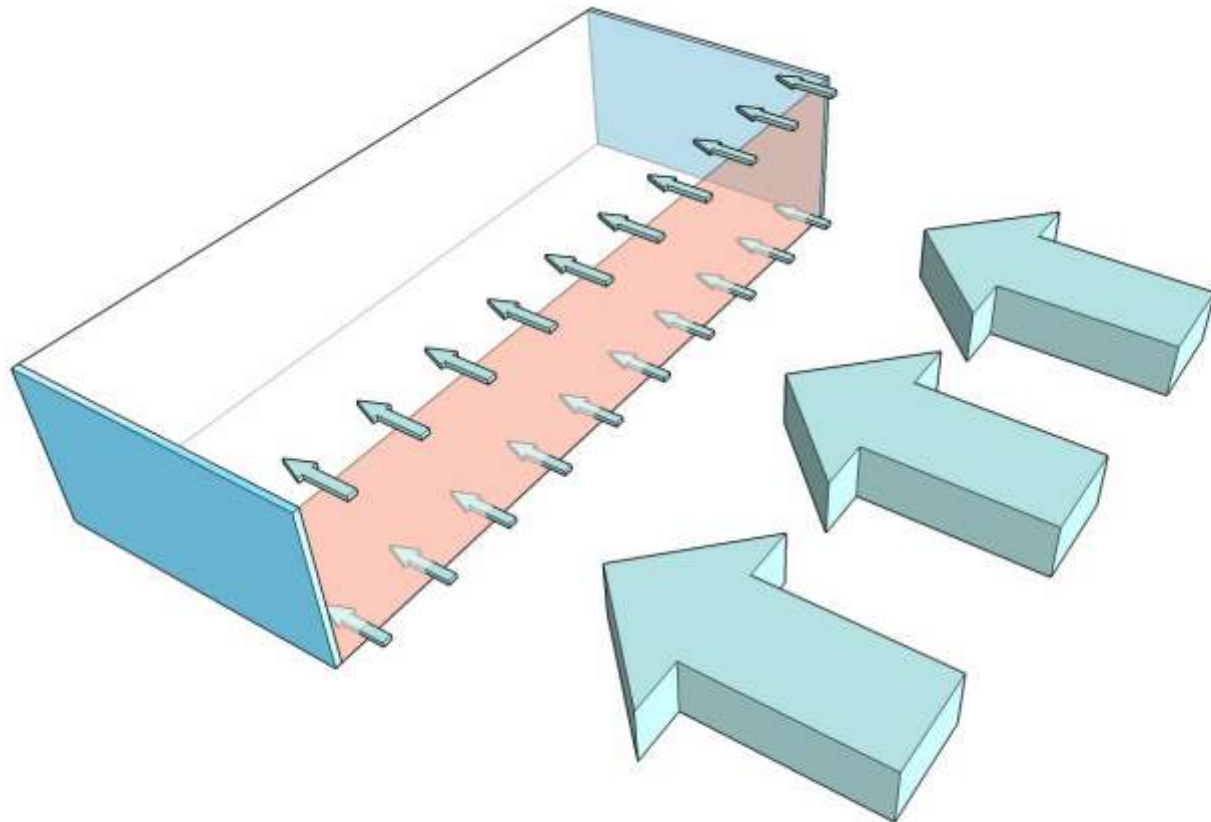

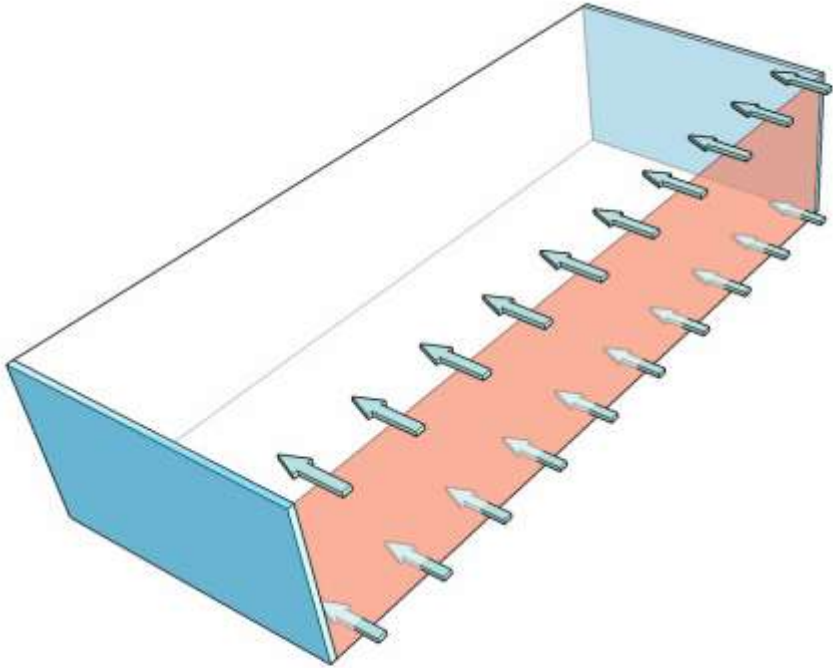

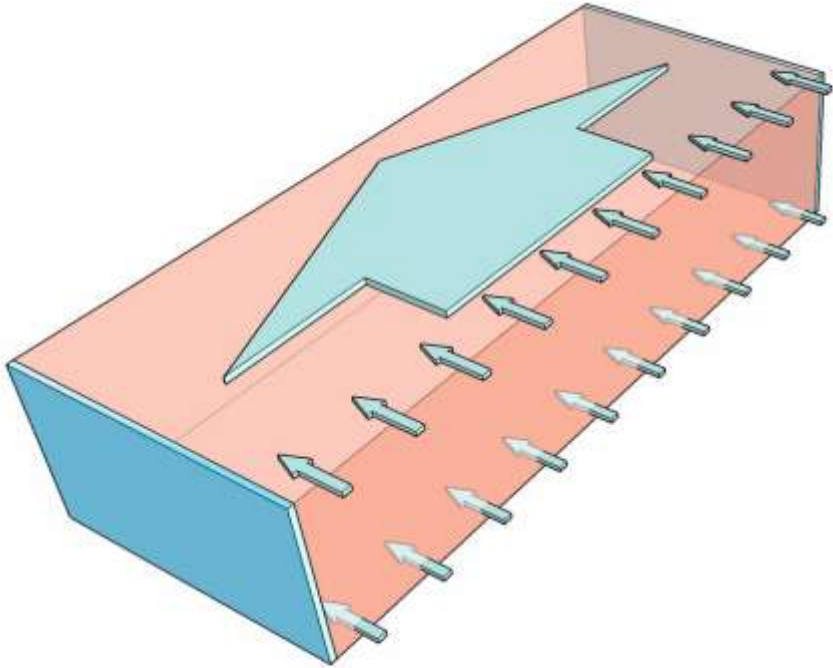

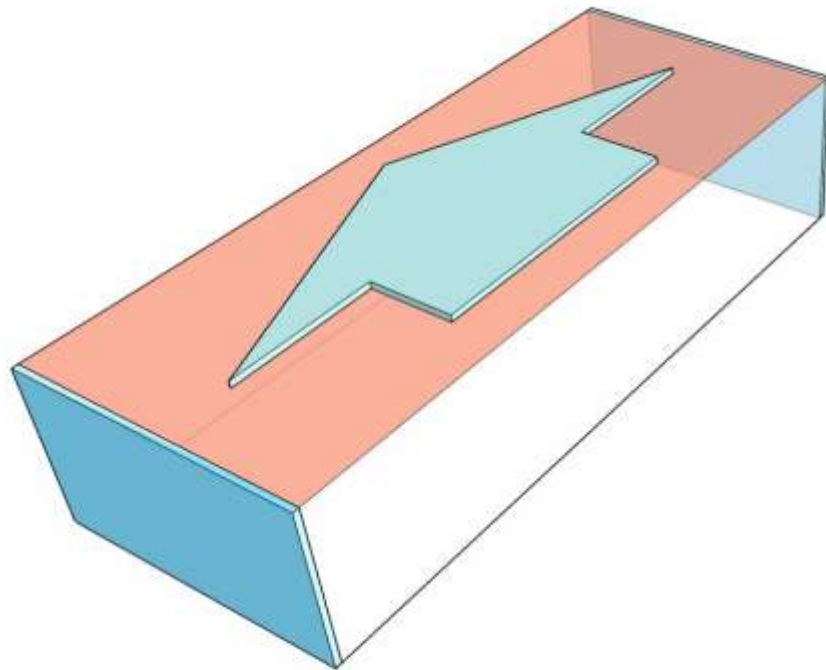

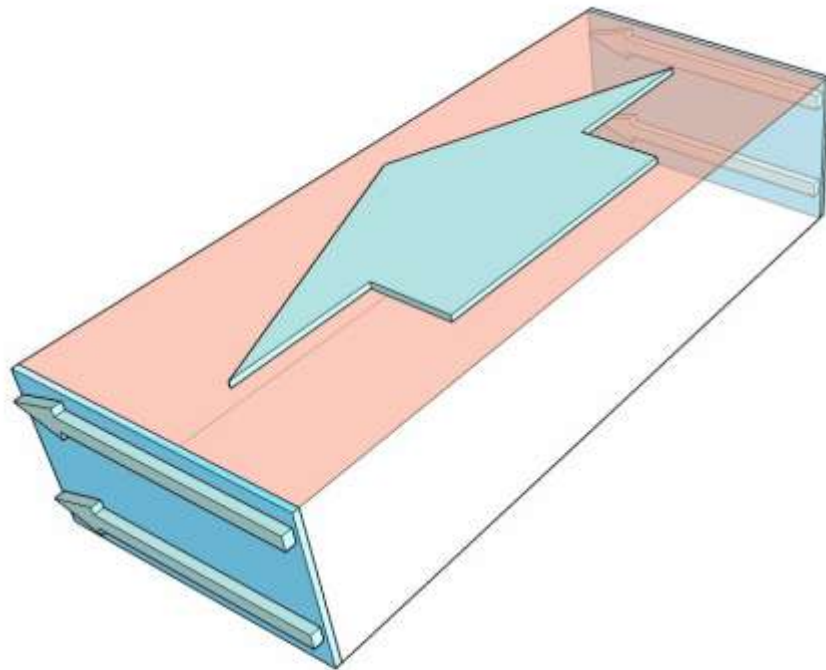

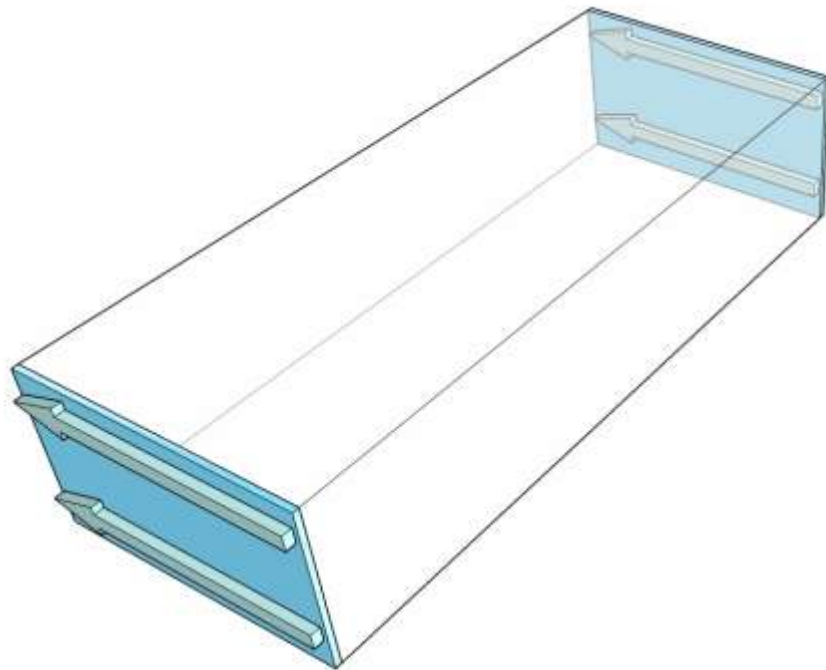

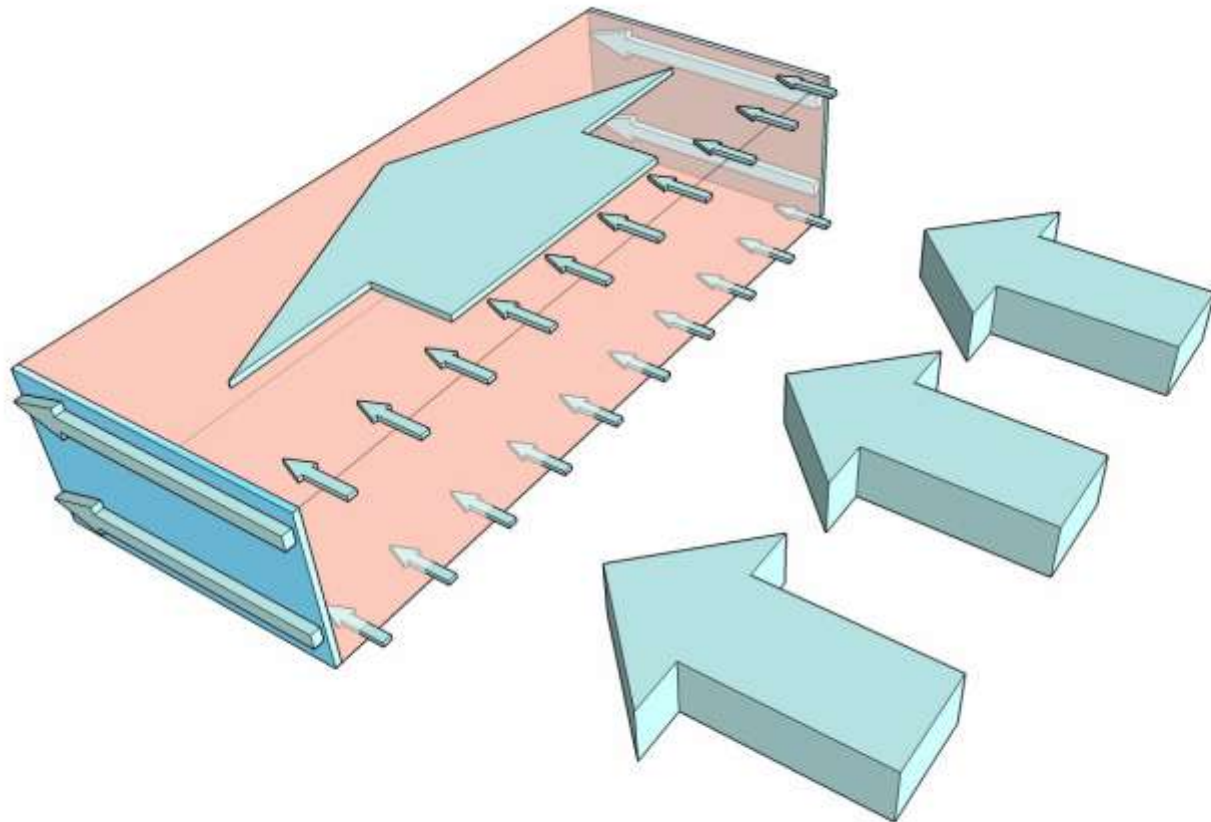

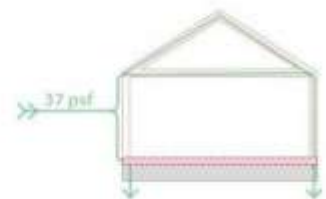
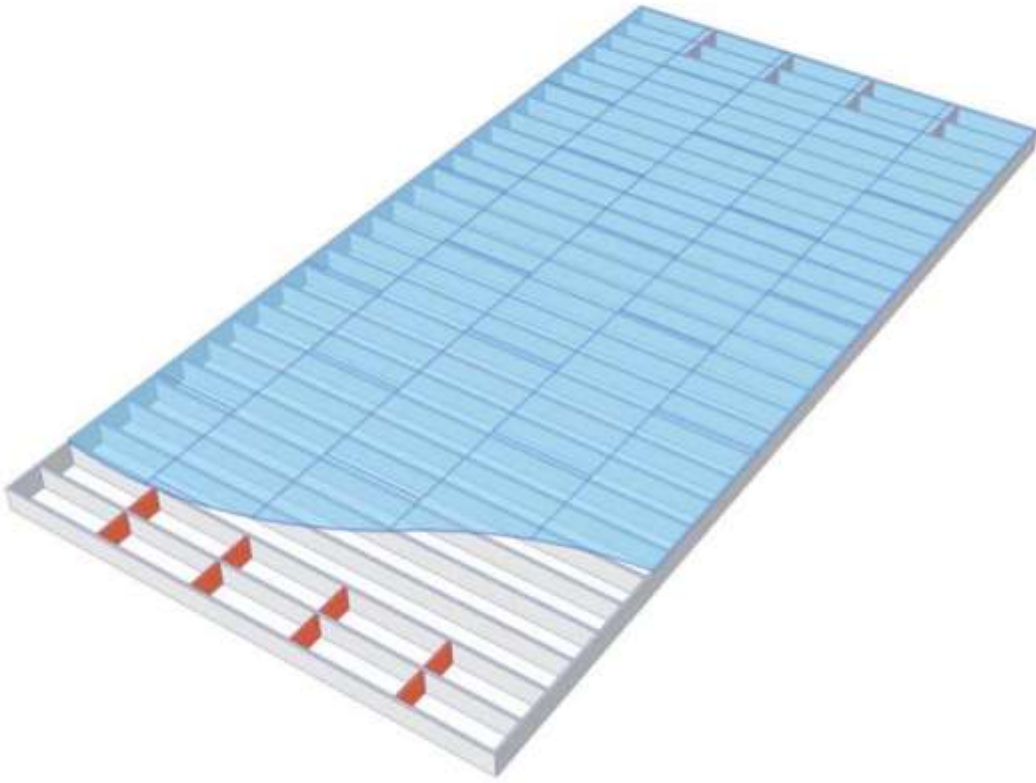

HORIZONTAL LOAD PATH - DIAPHRAGMS

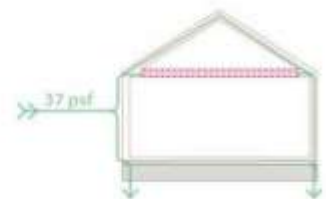
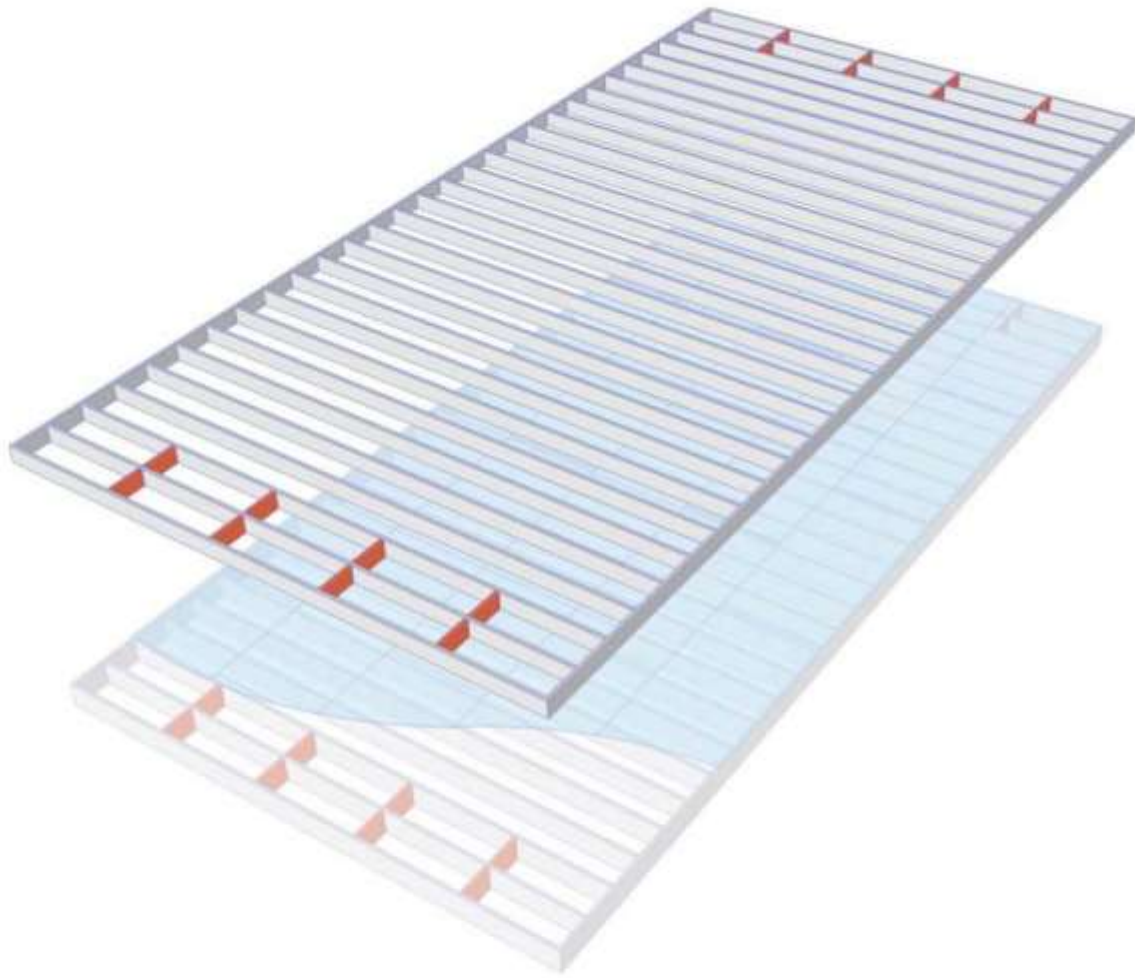

HORIZONTAL LOAD PATH - DIAPHRAGMS

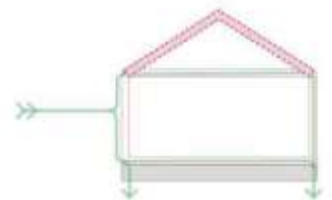
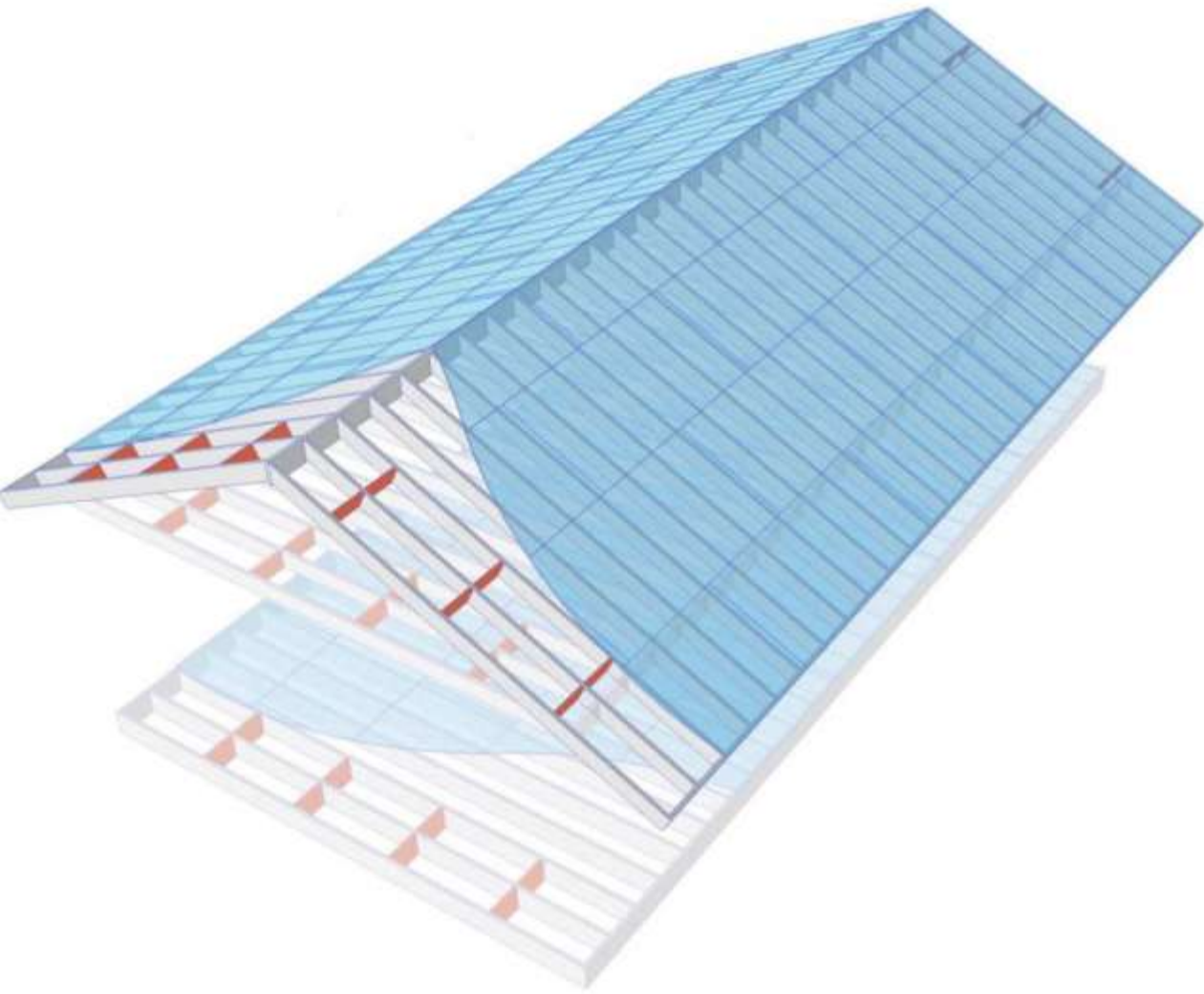

HORIZONTAL LOAD PATH - DIAPHRAGMS

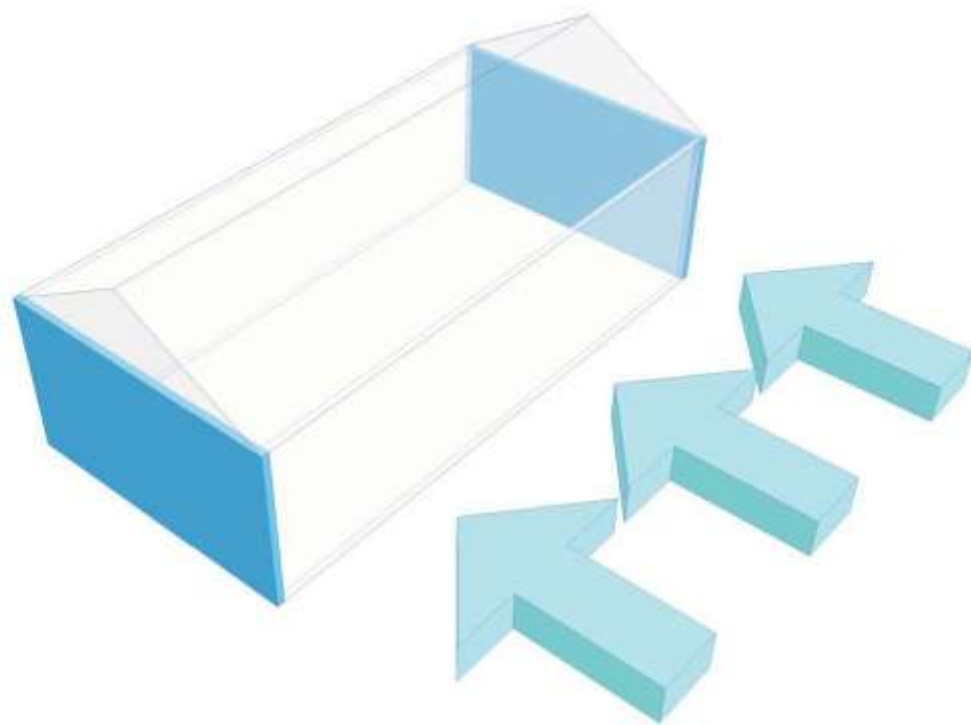

SHEAR RESISTANCE PERPENDICULAR TO LOAD

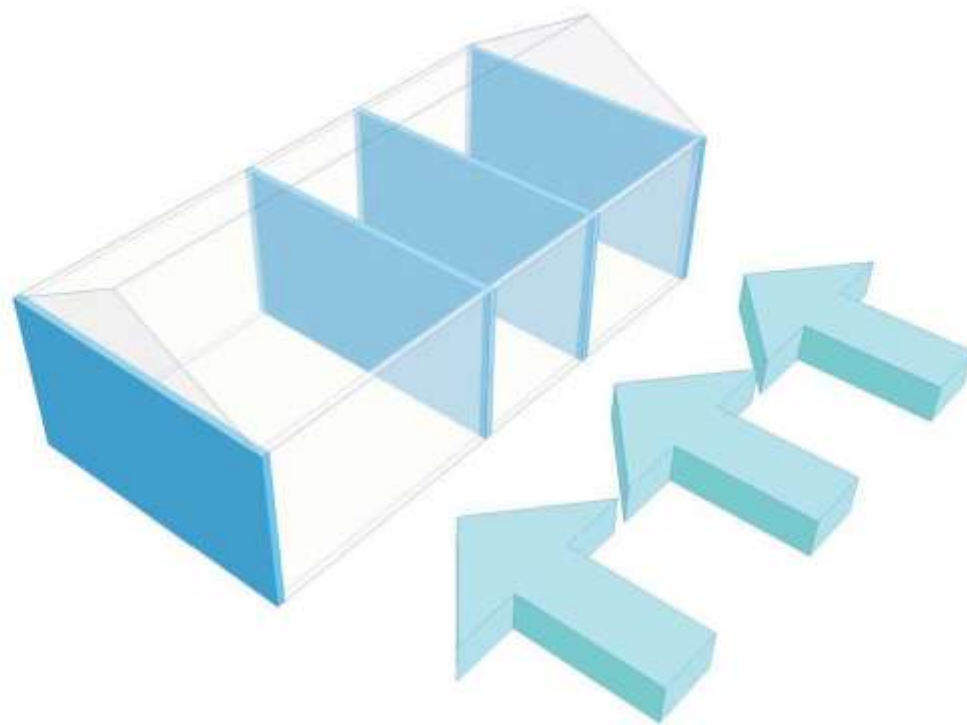

SHEAR RESISTANCE PERPENDICULAR TO LOAD



HORIZONTAL LOAD PATH

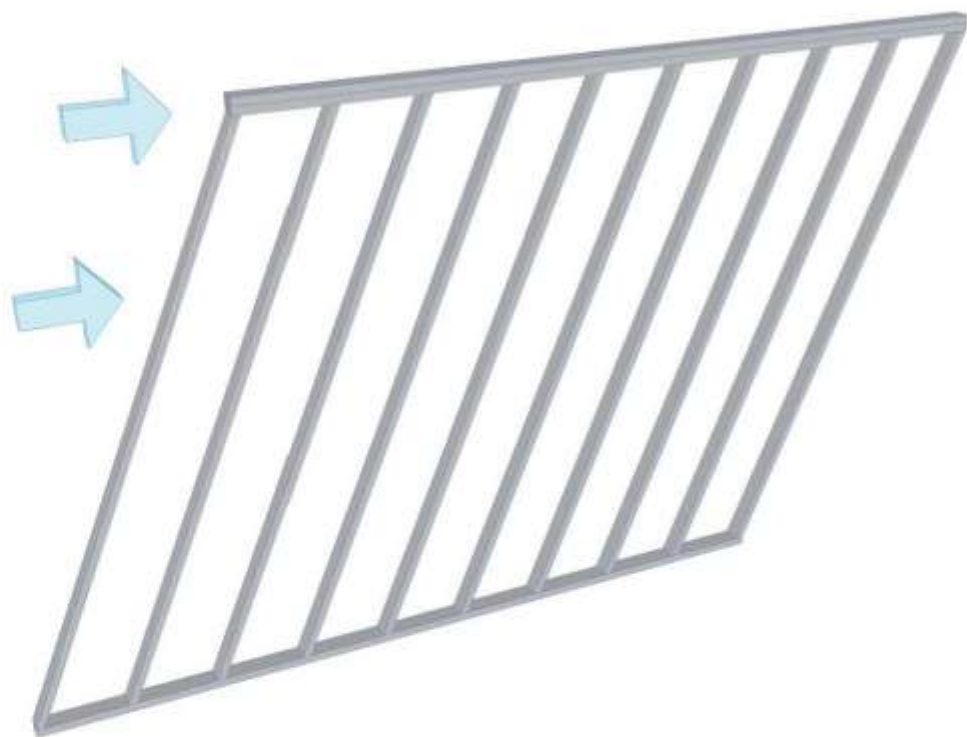

HORIZONTAL LOAD PATH

**MIN. SEGMENT LENGTH AT CORNER
MUST BE 34" FOR A 9' WALL**

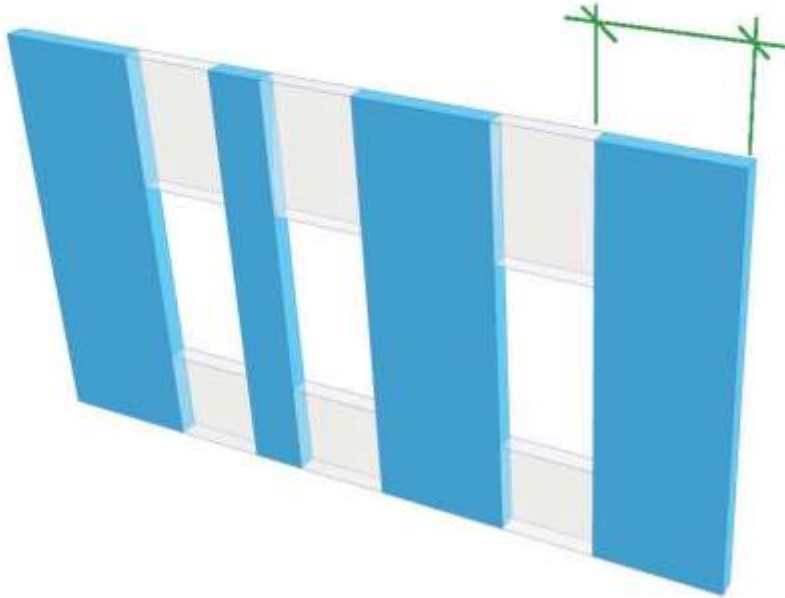

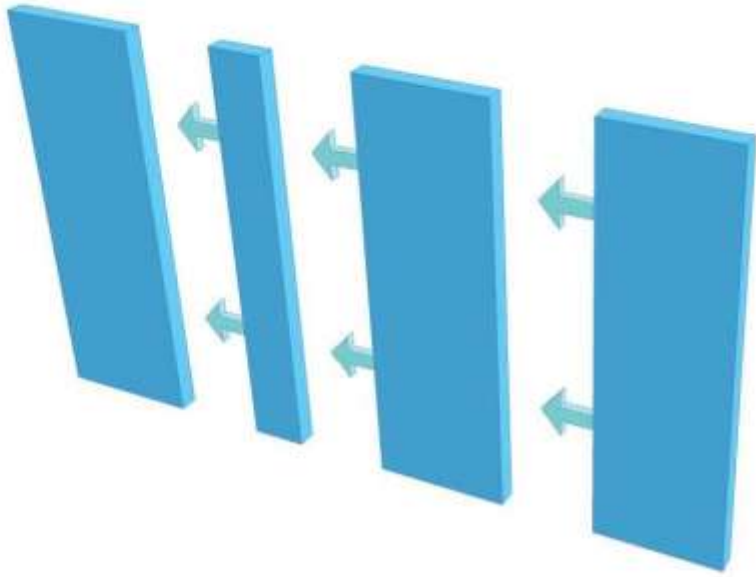

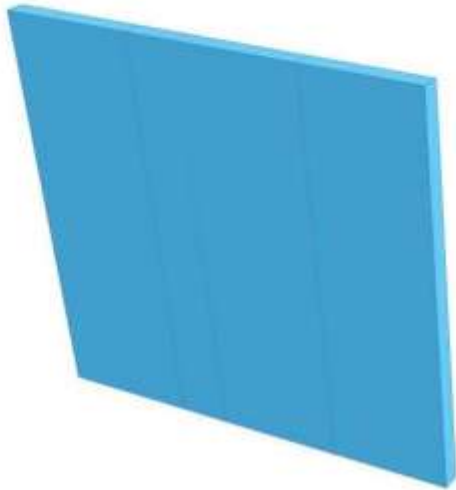

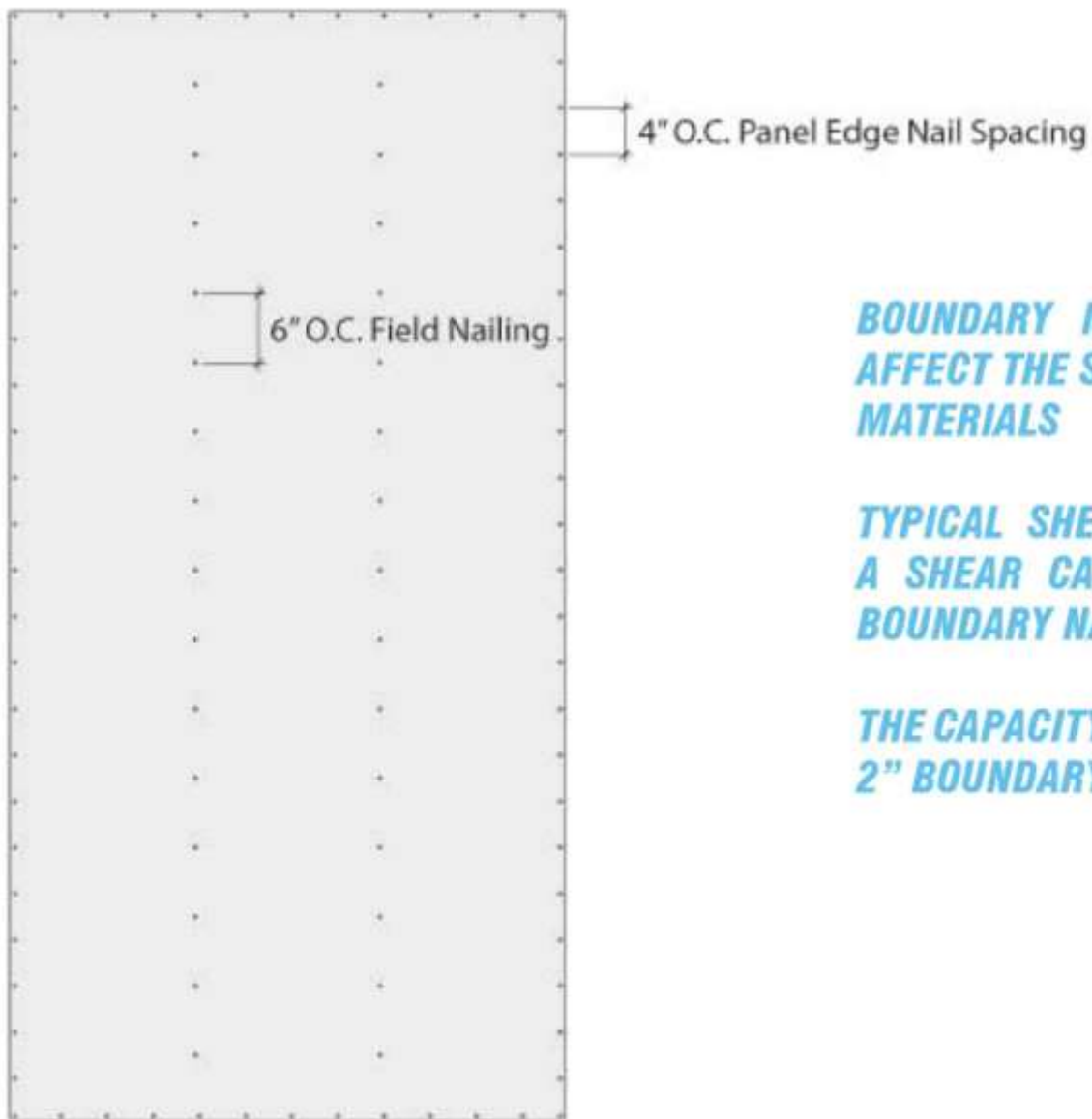

BOUNDARY NAILING CONDITIONS GREATLY AFFECT THE SHEAR CAPACITY OF SHEARWALL MATERIALS

TYPICAL SHEATHING GRADE PLYWOOD HAS A SHEAR CAPACITY OF 320 plf USING 6" BOUNDARY NAILING

THE CAPACITY IS INCREASED TO 840 plf USING 2" BOUNDARY NAILING

SSTD 10-99

Panel Edge Nail Spacing varies from 2" O.C. to 6" O.C.
Intermediate nailing varies from 6" O.C. to 12" O.C.

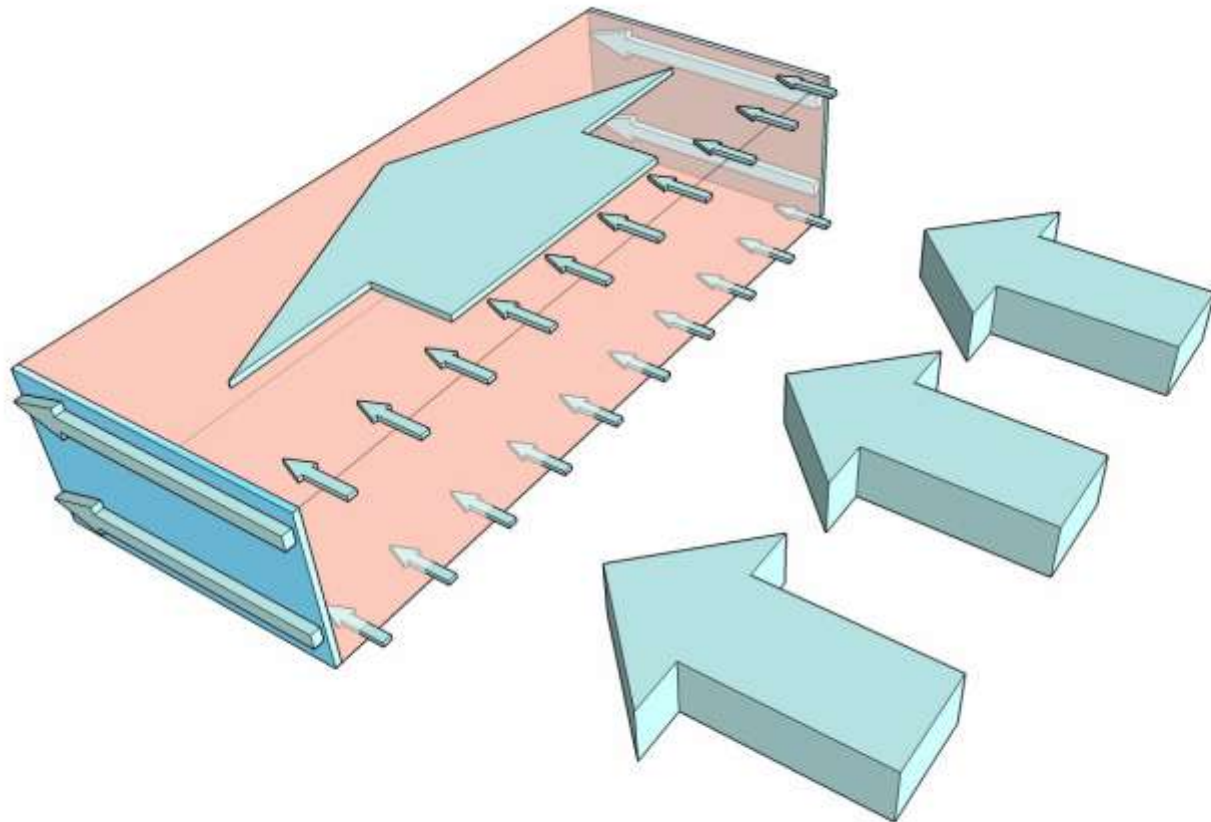

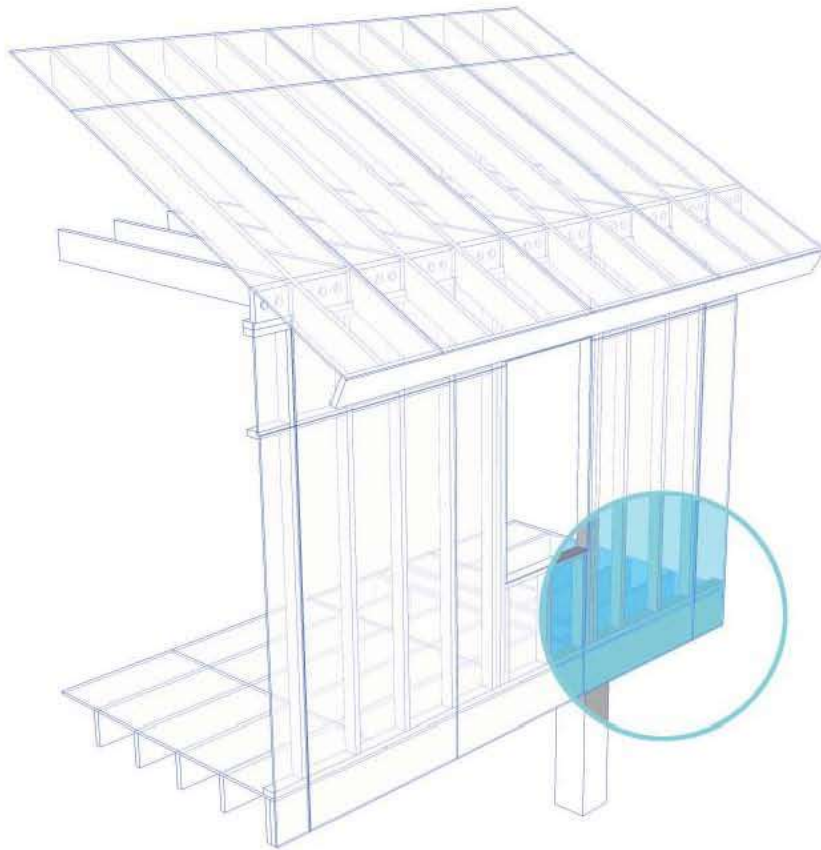

***SHEATHING TO LAP RIM BOARD
- BOUNDARY NAILING INTO SOLE
PLATE***

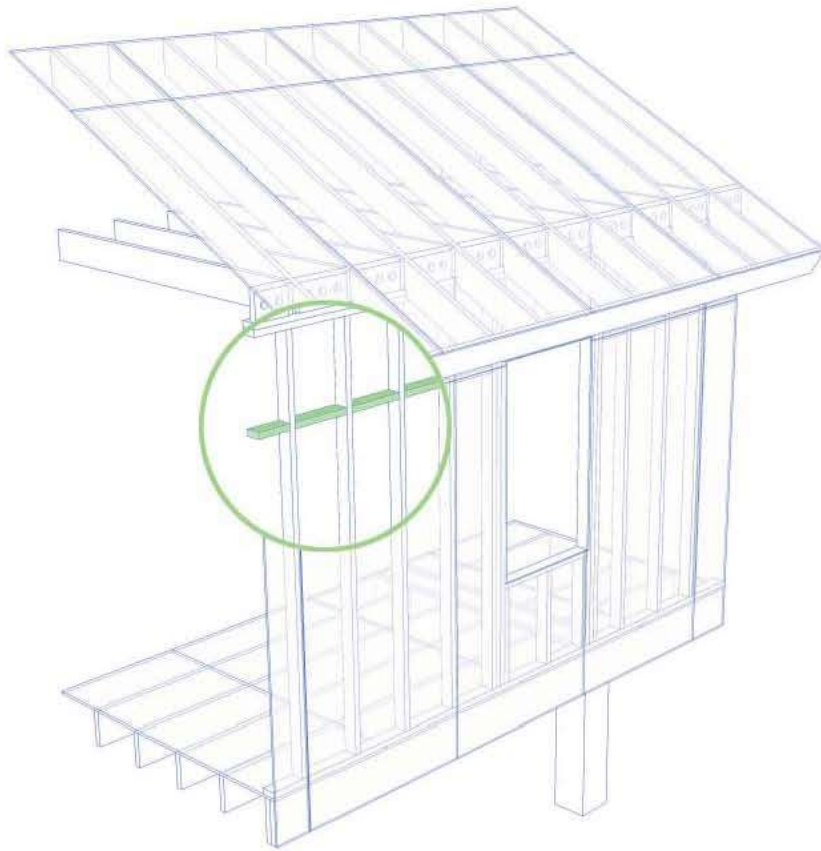

ADD SOLID 2x BLOCKING AT SHEATHING JOINTS

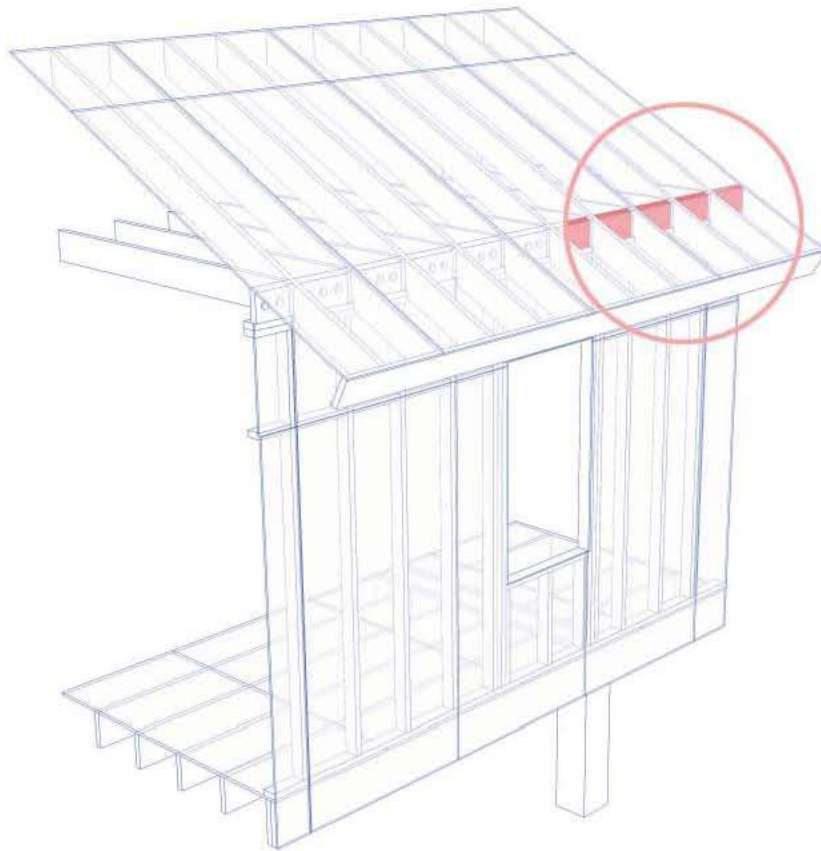

***SHEATHING MUST BE USE BOUND-
ARY NAILING PATTERN THRU VENT-
ED BLOCKING***

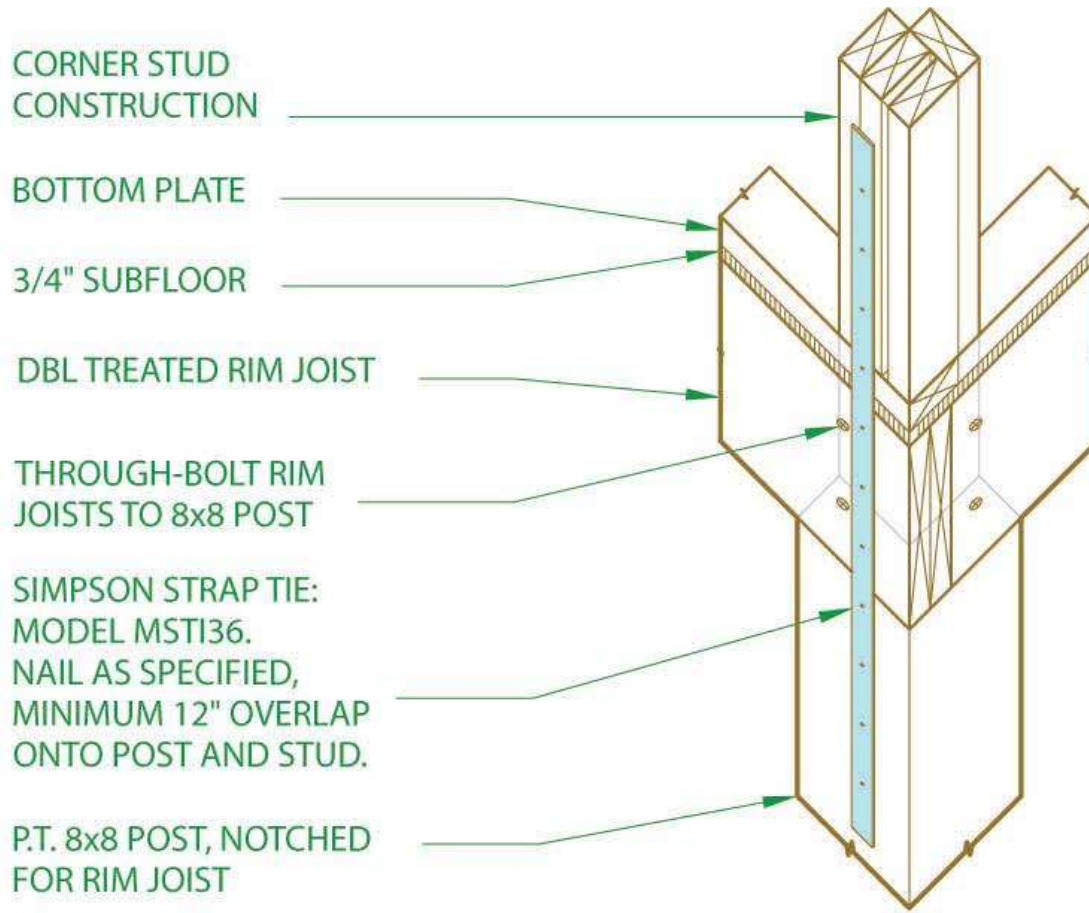

NOTE: EXTERIOR SHEATHING TO RUN
FROM BOTTOM OF RIM JOIST TO TOP
OF WALL PLATE; NAIL AS PER SPECS.

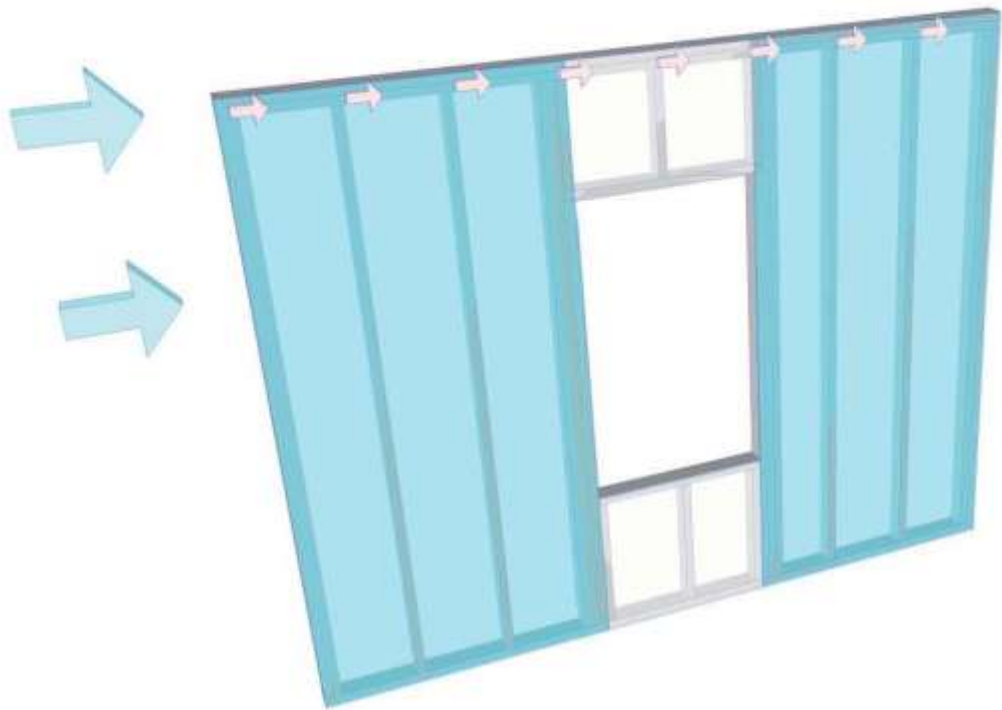

TOP PLATE - DRAG STRUT

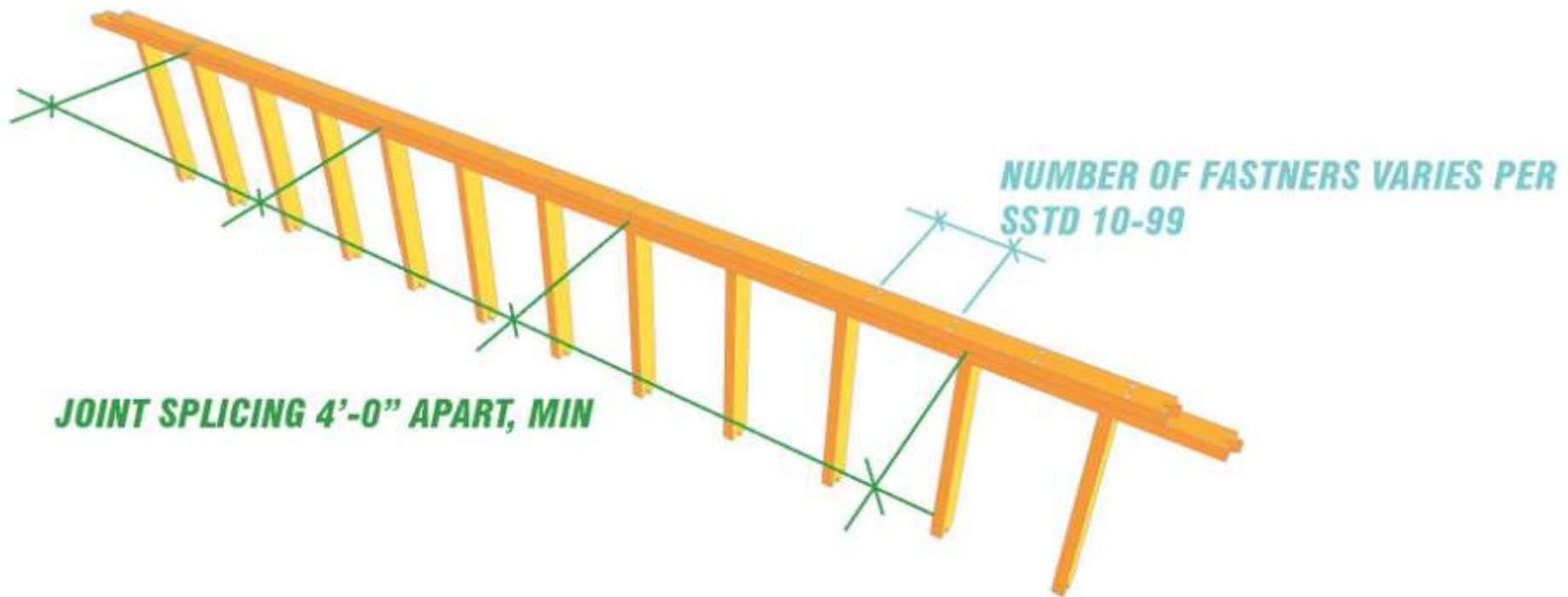



09/19/2007

RESOURCES

SSTD 10-99: STANDARD FOR HURRICANE RESISTANT RESIDENTIAL CONSTRUCTION

SOUTHERN BUILDING CODE CONGRESS INTERNATIONAL

ACSE 7-98: MINIMUM DESIGN LOADS FOR BUILDINGS AND OTHER STRUCTURES

AMERICAN SOCIETY OF CIVIL ENGINEERS

FEMA COASTAL CONSTRUCTION MANUAL

INTERNATIONAL BUILDING CODE - IBC 2003/2006